

# Power Switch 0.5A 125V AC Qualified Type

SDKN Series

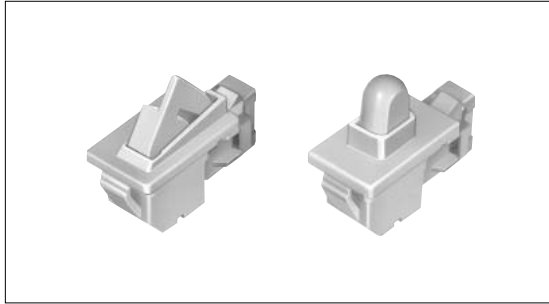

Compact and low-profile for primary/secondary switching with compatibility to low level rating.



## Product Line

| Circuit arrangement | Rating                                     | Total travel (mm) | Operating force | Mounting method | Operation type | Minimum order unit(pcs.) | Product No. | Drawing No. |
|---------------------|--|-------------------|-----------------|-----------------|----------------|--------------------------|-------------|-------------|
| SPDT                | 0.5A 125V AC<br>0.25A 250V AC<br>5mA 5V DC | 9                 | 3.5 ± 1N        | Snap-in         | Push           | 1,250                    | SDKNA20600  | 1           |
|                     |  | 9.7               | 2 ± 1.5N        |                 | Lever          |                          | SDKNA20700  | 2           |

## Notes

- Safety standard approval must be obtained as a set.
- Please place purchase orders per minimum orders units(integer).

## Dimensions

Unit:mm

| No. | Style              | Mounting hole dimensions |
|-----|--------------------|--------------------------|
| 1   | <p><b>Push</b></p> |                          |

Detector

Push

Slide

Rotary

Encoders

**Power**

Dual-in-line  
Package Type

TACT Switch™

Custom-  
Products

**Push  
Type**







Rocker  
Type

Slide  
Type

Rotary  
Type



## List of Varieties

| Items                       | Type                         | Push  |   |   |   | Rocker  |   |
|-----------------------------|------------------------------|---|---|---|---|---|---|
|                             | Series                       | SDKN  | SDKS  | SDKQ  | SDKR  | SDDJE <sup>1</sup> / <sub>2</sub>   | SDDJF <sup>1</sup> / <sub>2</sub>   |
| Photo                       |                              |  |  |  |  |  |  |
| Travel (mm)                 |                              | 9<br>9.7  | 14.6  | 2.5   | 1.5   | 3.5   | 5.2   |
| Remark                      |                              |   |   |   | Water-proof type  |   |   |
| Operating temperature range |                              | -20 to +60  | -30 to +60  | -10 to +60  | -10 to +85  | -10 to +55  |   |
| Rating                      |                              | 0.25A 250V AC<br>0.5A 125V AC<br>5mA 5V DC  | 2A 250V AC<br>4A 125V AC  | 3A 125V AC  | 0.5A 250V AC<br>1A 125V AC  | 6A/96A 250V ~   | 16( 6 )/250 ~   |
| Electrical performance      | Contact resistance           | 100m max.   | 50m max.  | 100m max.   |   |   |   |
|                             | Insulation resistance        | 500M min.<br>500V DC  | 100M min.<br>500V DC  | 500M min. 500V DC   |   |   |   |
|                             | Voltage proof                | 1,000V AC for 1minute   | 1,500V AC for 1minute   |   | 1,000V AC for 1minute   | 2,000V AC for 1minute   |   |
| Mechanical performance      | Terminal strength            | 50N for 1minute   | 70N for 1minute   |   | 5N for 1minute  | 10N for 1minute   | 60N for 1minute   |
|                             | Actuator strength            | Operating direction   | 20N   |   | 100N  | 25N   |   |
|                             |                              | Perpendicular direction   | 20N   | 30N   | 20N   | 25N   |   |
|                             | Resistance to soldering heat | Manual soldering  |   |   |   | 300 ± 10 ,<br>3 ± 0.5s  | 350 ± 10 , 3 ± 0.5s   |
| Dip soldering               |                              |   |   |   | 260 ± 5 ,<br>10 ± 1s  | 260 ± 10 , 10 ± 1s  |   |
| Durability                  | Operating life               | 6,000cycles   |   | 12,000cycles  | 100,000cycles   | 10,000cycles  |   |
|                             |                              | Load : as ratings   |   |   |   | Refer to individual product spec.   | Load : as ratings   |
| Environmental performance   | Cold                         | -30 ± 2 for 96h   | -40 ± 2 for 96h   | -25 ± 2 for 240h  | -20 ± 2 for 240h  | -20 ± 2 for 96h   |   |
|                             | Dry heat                     | 85 ± 2 for 96h  |   | 85 ± 2 for 240h   |   | 85 ± 2 for 96h  |   |
|                             | Damp heat                    | 40 ± 2 ,<br>90 to 95%RH for 96h   |   | 40 ± 2 ,<br>90 to 95%RH for 240h  | 60 ± 2 ,<br>90 to 95%RH for 1000h   | 40 ± 2 , 90 to 95%RH for 96h  |   |
| Page                        |                              | 215   | 217   | 219   | 220   | 221   | 225   |

Detector

Push

Slide

Rotary

Encoders

Power

Dual-in-line  
Package Type

TACT Switch™

Custom-  
Products

Push  
Type

Rocker  
Type

Slide  
Type

Rotary  
Type

Power Switches Cautions .....235  
 Power Switches Safety Standard .....237, 238, 239

### Notes

1. Dip soldering can be used on SDDJE For PC board terminal and SDDJF right angle terminal types only.
2. The operating temperature range for automotive applications can be raised upon request. Please contact us for requirements of this kind.